



# INSTALLATION

## DELUXE PANACEA MULTI-FUNCTION TAILLIGHT

## 5422

### PARTS INCLUDED

- 1 Deluxe Panacea Taillight with Smoke Lens and Chrome Trim with Plate Light
- 1 Plug-in Panacea Master Control Assembly Kit, including:
  - 1 Alarm Compatible Load Equalizer
  - 1 Panacea Control Module
  - 1 "Stock" Control Tab (**for use on Full Coverage Fender**)
  - 1 "Inverted" Control Tab (**for use on Bobbed Fender**)
- 1 Taillight Gasket with Adhesive Backing
- 1 Adapter Kit, including:
  - 1 Evolution Style 1157 Base Connector
  - 1 Twin Cam Taillight Connector
  - 1 Accessory Light Plug-in Adapter for Twin Cams
  - 1 LED Fender Tip Replacement Light Chip
  - 1 Dielectric Grease
- 1 Installation Instructions

*Please read and understand entire instructions before starting installation.*

### THANK YOU FOR CHOOSING KÜRYAKYN!

**IN ORDER TO PROTECT YOU AND OTHERS FROM POSSIBLE INJURY AND/OR PROPERTY DAMAGE OR LOSS, PLEASE PAY CLOSE ATTENTION TO ALL INSTRUCTIONS, WARNINGS, CAUTIONS AND ATTENTION NOTES REGARDING THE USE AND CARE OF THIS PRODUCT.**

**ATTENTION!** This indication alerts you to the fact that ignoring the contents described herein may negatively affect product performance and functionality.

**CAUTION!** This indication alerts you to the fact that ignoring the contents described herein can result in potential injury or material damage.

### TOOLS SUGGESTED

Phillips Screwdriver, Small Flat Blade Screwdriver.

**STRICTLY OBSERVE THE FOLLOWING GUIDELINES IN ORDER TO USE THE PRODUCT PROPERLY AND AVOID POTENTIALLY DANGEROUS ACCIDENTS.**

### ATTENTION!

This Panacea product complies with FMVSS #108 when the controller supplied with the Panacea Taillight is operated in "DOT Mode". When in "DOT Mode", the Panacea Taillight and both Panacea Turn Signals will illuminate red as running lights, bright red as brake lights, and the appropriate Panacea Turn Signal will flash amber when a turn signal is activated. FMVSS #108 makes no provision for flashing brake or amber indicators within the taillight, so those features are disabled when "DOT Mode" is selected on the controller. Selecting "Panacea Mode" on the controller enables the flashing brake light feature and the amber chevron within the taillight when a turn signal is activated. Operation in Panacea Mode is at the discretion of the customer and Kuryakyn assumes no liability for situations created from operating these lights in Panacea Mode.

### CUSTOMER SERVICE

877.370.3604 (toll free)

### INSTALLATION QUESTIONS

techsupport@kuryakyn.com  
or call 715.247.2983

### LIMITED WARRANTY

Kuryakyn warrants that any Kuryakyn products sold hereunder, shall be free of defects in materials and workmanship for a period of one (1) year from the date of purchase by the consumer excepting the following provisions:

- Kuryakyn shall have no obligation in the event the customer is unable to provide a receipt showing the date the customer purchased the product(s).
- The product must be properly installed, maintained and operated under normal conditions.
- Kuryakyn makes no warranty, expressed or implied, with respect to any gold plated products.
- Kuryakyn shall not be liable for any consequential and incidental damages, including labor and paint, resulting from failure of a Kuryakyn product, failure to deliver, delay in delivery, delivery in nonconforming condition, or for any breach of contract or duty between Kuryakyn and a customer.
- Kuryakyn products are often intended for use in specific applications. Kuryakyn makes no warranty if a Kuryakyn product is used in applications other than intended.
- Kuryakyn electrical products are warranted for one (1) year from the date of purchase by the consumer. L.E.D.'S contained in components of Kuryakyn products will be warranted for defects in materials and workmanship for 3 years from the date of purchase where as all other components shall be warranted for one(1) year. This includes, but is not limited to; control modules, wiring, chrome & other components.
- Kuryakyn makes no warranty of any kind in regard to other manufacturer's products distributed by Kuryakyn. Kuryakyn will pass on all warranties made by the manufacturer and where possible, will expedite the claim on behalf of the customer, but ultimately, responsibility for disposition of the warranty claim lies with the manufacturer.

### ABOUT OUR CATALOG

For purchasing Kuryakyn® products, you can receive a complete catalog free of charge.

Send the Proof-of-Purchase below with your address to: Kuryakyn, P.O. Box 339, Somerset, WI 54025.

Please indicate either Accessories Catalog for Harley-Davidson® or GL & Metric Cruisers.

Be sure to ask your local dealer about other Kuryakyn® products, the motorcycle parts and accessories designed for riders by riders.

©2005 Kuryakyn USA® All Rights reserved.



-cont.-

5422-22HD-0212

kuryakyn.com

## STEP 1

Read and understand all steps in the instructions before starting the installation. Park the motorcycle on a hard, level surface and turn off the ignition.

**Küryakyn®**

**NOTE** For the complete Panacea set (multi-function taillights and turn signals), the following turn signal inserts must be ordered separately. **No other turn signals** will provide multi-function (run, turn, brake) operation with the Panacea system.

**P/N 5428 or 5429 – Flat 3 1/4" "Pancake" Style**  
**P/N 5430 or 5431 – Bullet Type**

**ATTENTION!** This product is only compatible with motorcycles that have stock wiring configurations. Before attempting to install this product verify the following conditions:

- If the rear turn signals have been replaced with dual circuit turn signal assemblies, the stock single circuit assemblies must be reinstalled and all wiring returned to its original configuration.
- If additional lights have been added to the rear of the motorcycle they must either be connected to the motorcycle accessory circuit, spliced into the stock wiring harness upstream of the input side of the control module, or connected to the accessory harness supplied with this kit.
- All trailer wiring connections must be spliced into the stock wiring harness upstream of the input side of the control module.

## STEP 2

Remove the taillight lens; save the stock fasteners.

**For Twin Cam and '02 and later XL models:** Remove the stock taillight lens assembly and unplug it from the fender mounted taillight base.

**For '94-'99 Evolution models:** Remove the taillight lens and unplug the bulb.

**ATTENTION!** Küryakyn recommends the use of dielectric grease on electrical connections.

## STEP 3

Install the correct taillight adapter for your bike. Apply a dab of dielectric grease to the adapter pins before connecting.

**For Twin Cam and '02 and later XL models:** The "Amp" style adapter plugs into the taillight base in the same manner as the stock taillight; the adapter is keyed to fit only one way. PIC 1

**For '94-'99 Evolution models:** The adapter installs like an 1157 light bulb; push the adapter in and turn it clockwise. PIC 2

## STEP 4

Clean the inside of the taillight base in the area of the gasket; dirt and other contaminants will prevent the gasket from adhering to the base. Remove the paper backing from the self-adhesive gasket and apply the gasket to the taillight base on the fender. The extra flap in the gasket is designed to seal the wire opening in the taillight base on Twin Cam and XL models. If you normally drive in wet weather, you may want to seal the wire opening with silicone or electrical tape for extra protection. PIC 3 and PIC 4

## STEP 5

Plug the taillight into the adapter; be sure like colored wires are aligned. The small black plugs are usually a tight fit — some effort may be required to seat the taillight into the adapter.

**For Twin Cam and '02 and later XL models only:** The adapter has an extra wiring harness coming from the taillight connector, see PIC 1. Use this extra harness to power an accessory such as a separate license plate light, LED bottom fender trim or any rear end lighting that is not original equipment. Wire functions are labeled to aid in making the correct connections. If you do not have accessory lighting, remove the pigtail from the connector to avoid a possible short circuit.

## STEP 6

Install the Panacea taillight onto the taillight base using the stock fasteners.

-cont.-

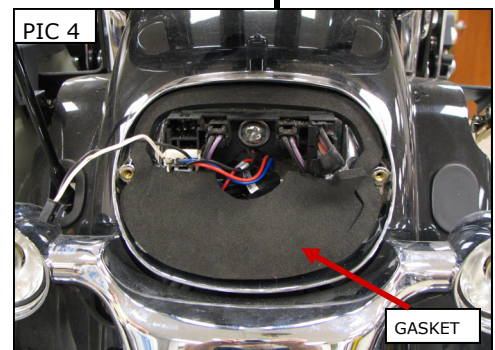
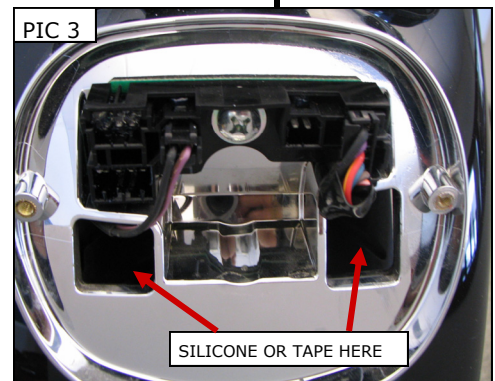
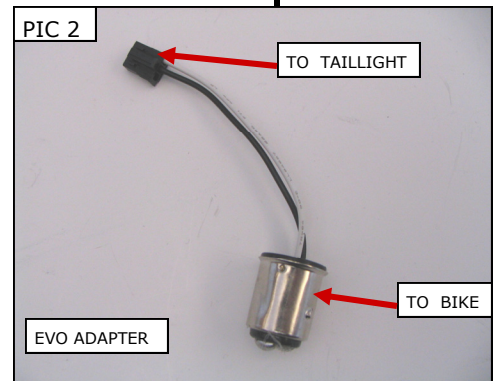
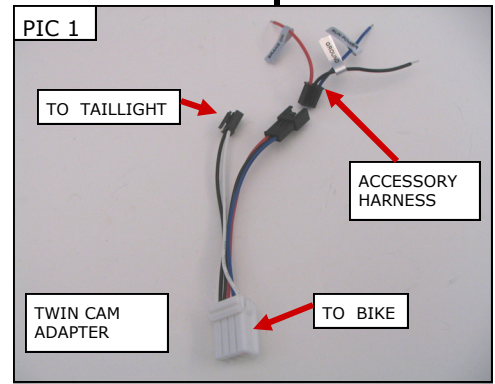

PAGE  
2

**DELUXE PANACEA TAILLIGHT**

**INSTALLATION**

## Set Up and Install the Panacea Control Module.

**Note** 2004 and later Sportster models will require a six pin to eight pin adapter, part number 4831, sold separately, for installation of the Panacea controller.

**STEP 7** Verify the "stock" tab is installed in the end of the control module. PIC 5

**Note** Installation of the Panacea taillight on models with "bobbed" fenders where the tail light is turned upside down is accomplished by removing the "stock" tab and installing the "inverted" tab in it's place. **Be sure the ignition is "Off" before** removing and replacing the tabs.

**STEP 8** **With the ignition "Off"**, set the selector switch on the control module for your particular turn signal application. A small, flat blade screwdriver works well to set the selector switch. PIC 6

**For complete Panacea systems, using Panacea turn signal inserts:**

Set the selector switch on the module to the "Panacea" position.

**For stock or any other single filament or single circuit LED turn signals:**

Set the selector switch on the control module to the "Stock/ Other" position.

**STEP 9** **With the ignition "Off"**, set the operation mode switch to your preferred mode. PIC 7

**Panacea mode** pulses the brake lights several times before steady bright illumination when the brake is applied and allows the chevrons in the taillight to operate as turn signals when the turn signals are activated.

**DOT mode** illuminates the brake lights in steady bright when the brake is applied and makes the chevrons in the taillight inoperative so the light is DOT compliant. The turn signals will still be multi-functional in this mode—Red for running, Bright Red for brake and Amber for turns.

**STEP 10** Verify the supplied load equalizer is plugged into the 3-pin connector at the end of the control module if using Panacea turn signals or LED conversion turn signals or no outboard turn signals. PIC 8

**For models with optional front LED turn signals or no front turn signals:**

An additional load equalizer must be used (**NOT INCLUDED**); attach the equalizer to the second connector on the control module. PIC 8

**CAUTION!** Always install the load equalizer in the provided connectors on the Panacea controller. Do not install a load equalizer between a module and the turn signals as this will overload the equalizer. Overloading will damage the equalizer and may create a fire hazard!

**CAUTION!** Load equalizers generate heat when in use. Avoid using the turn signals for an extended period of time, otherwise the load equalizer will overheat. Never operate the four-way flashers unless you first remove the load equalizer. Overheating will damage the load equalizer, causing loss of turn signal operation and may create a fire hazard!

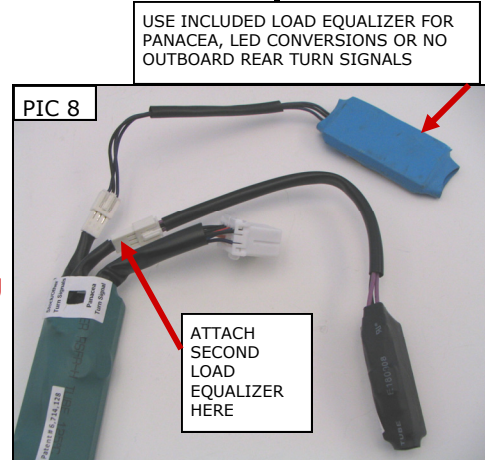
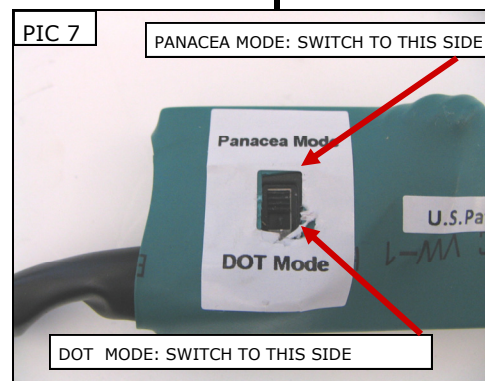
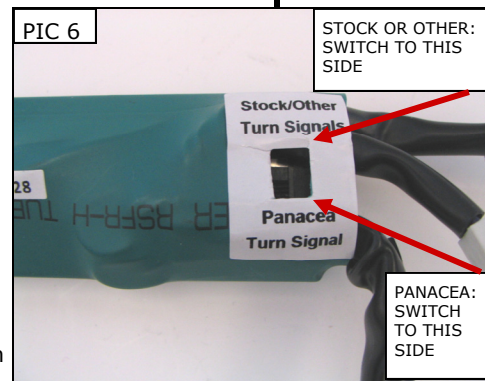
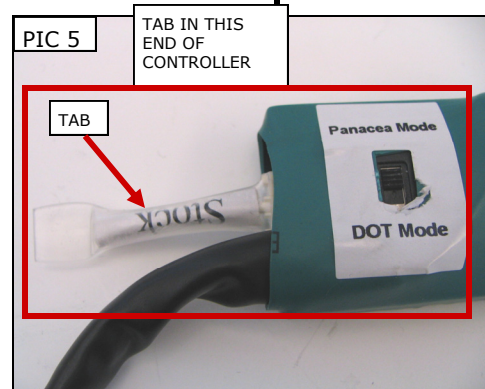



## STEP 11

Locate the main wiring harness going to the rear fender; the harness is located either under the seat or behind the side cover PIC 9. Separate the harness at the main connector plug and install the control module inline. The connectors are keyed to only fit one way; be sure the connectors seat fully for good electrical contact PIC 10. **Make sure there are no other modules plugged in here. You cannot use any other control modules when the Panacea module is installed. If you have a trailer wiring harness installed on the bike, it will need to be upstream of the Panacea control module.**

**ATTENTION!** Küryakyn recommends the use of dielectric grease on electrical connections.

## STEP 12

Use nylon cable ties or twist ties to secure the load equalizer (if installed) tightly to either a frame rail or other metal surface—this will act as a heat sink to help cool the load equalizer when the turn signals are activated.

**CAUTION!** Never secure the load equalizer to the control module! Excess heat from the load equalizer could damage the control module.

## STEP 13

For models with a rear fender tip light: Replace the incandescent bulb with the supplied LED light chip to ensure proper taillight operation. If the LED does not illuminate after installation, remove the chip, reverse its position and reinstall.

## STEP 14

For optional license plate light or LED bottom fender light: Locate the power wire (black) in the connector for the accessory lights in the taillight base PIC 11; mark the wire for reference. Unplug the connector and cut it off the stock wiring harness. Connect the accessory harness, shown in PIC 1, Page 2, to the connector on the Panacea Taillight adapter. Connect the run wire (blue) from the accessory harness to the power wire you marked previously. Connect the ground wire (black) from the accessory harness to the ground wire from the accessory light. PIC 11 Verify the connections are secure. Test lights for proper operation.

**ATTENTION!** Test the lights with the engine running.

## STEP 15

Verify the taillight illuminates in running mode.

## STEP 16

Verify the brake light flashes or illuminates bright in stop mode, depending on your brake mode selection, when either front or rear brake is applied.

## STEP 17

Verify amber chevrons in the taillight illuminate on the correct side when the turn signals are activated if you are using the Panacea mode.

## CAUTION!

Load equalizers generate heat when in use. Avoid using the turn signals for an extended period of time, otherwise the load equalizer will overheat. Never operate the four-way flashers unless you first remove the load equalizer. Overheating damages the load equalizer causing loss of turn signal operation and could create a fire hazard!

